

PRODUCT, TECHNICAL CHARACTERISTICS AND FEATURES



220-240V AC / 50 Hz



LED

This product contains a light source of energy efficiency class C

References

as per label product.

Standard reference: **11xxxx00**
without detection

Standard reference: **11xxxx10**
with detection

Other references with options

Vandal-proof screw version:

Standard reference: **11xxxx009701**
without detection

Standard reference: **11xxxx109701**
with detection



Declaration of conformity:

Hereby SÉCURLITE declares that its devices comply with the essential requirements and other relevant provisions of Directive 2014/53/EU and 2011/65/EU. The full text of the EU declaration of conformity is available on our website: securlite.com

Dimensions

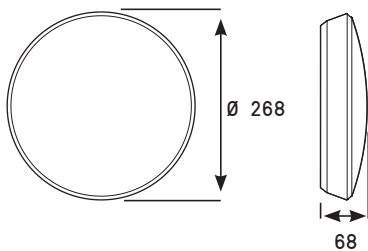

Composition

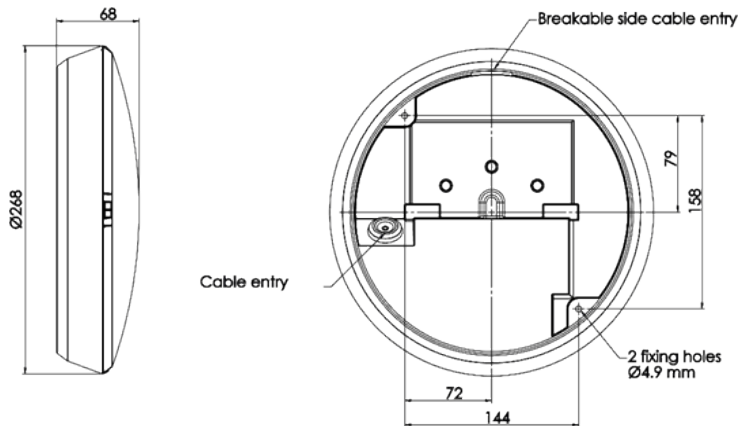

Conditions of use

Ceiling
(horizontal)

Wall
(vertical)



In wall-mounted installation, power supply in high position not allowed.

Standard installation kit

Cable grommet x1

Power

as per label product.

Input voltage range

198V – 264V AC

MOUNTING / INSTALLATION



Warning, versions employing LEDs are at risk from ESD (electrostatic discharges).



Fitting & installation must be carried out by a professional installer in accordance with current installation standards.



Isolate the power before fitting and connecting up.

Opening the luminaire



MOUNTING / INSTALLATION (SUITE)

Preparing the cable entry grommet

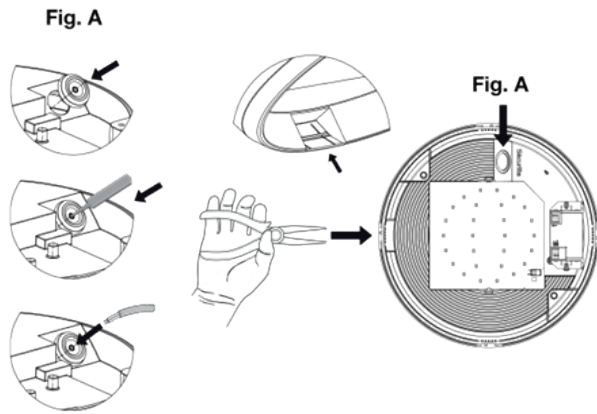

For side cable entry, use the knockouts provided in the luminaire base. In order to ensure the luminaire is sealed, it is vital to use the cable grommets.

Use 1.5 mm² U1000R2V type cable (recommended to maintain sealing).

Use a pointed object to pierce the centre of a cable grommet. Do not use a blade, which might weaken the grommet and impair sealing.

Fit the grommet into the cable entry and feed the supply cable through it.

Fixing

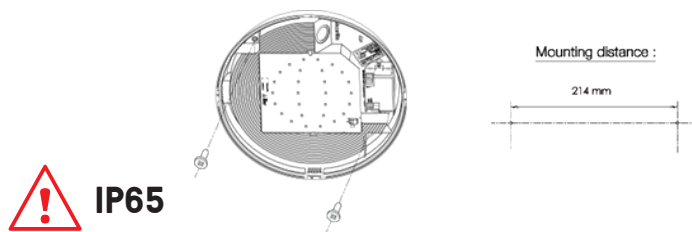

IP65
For mounting the luminaire, use \varnothing 4-4,5mm **screws with unserrated collar** \varnothing 8,5 mm. Or add sealing washer (ex EPDM d4,5 x D11 x 1,5 mm) under screw heads
Use fixing plugs suitable for the type of wall, in order to achieve optimum rip-out resistance.
The screws and plugs are not supplied with the luminaire.

Electrical connection

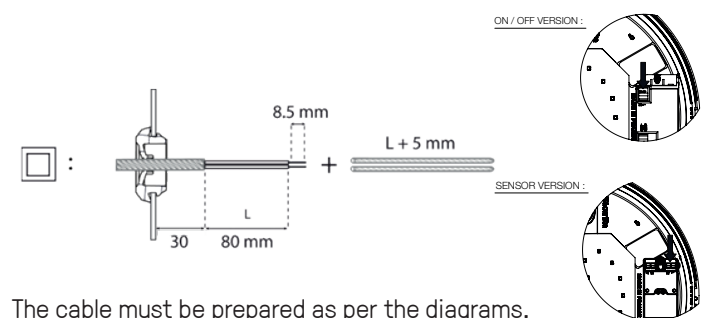

The cable must be prepared as per the diagrams. The conductors must be stripped for a length of 8.5mm. Respect the polarity.

! Osmo is a stand-alone luminaire for sensor setting refer to NOT0805

Closing the luminaire



Fig. C (vandal-proof version) :
Screw in the pre-mounted vandal-proof screw using tool reference **98110010**.

Tightening torque: 0,3 N.m

CLEANING

Cleaning of the luminaire is limited to cleaning the diffuser for proper light output. Clean the diffuser (with the luminaire closed) using a damp cloth or with soapy water.

! DO NOT USE DETERGENT

RECYCLABILITY



OSMO is an eco-designed luminaire:

All the plastic or metal components can be dismantled and recycled via appropriate facilities.

MAINTENANCE

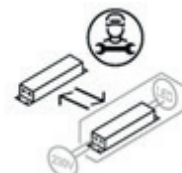

The light source combined in this luminaire must only be replaced by the manufacturer or his service agent or a person of equivalent qualification.



All the electronic components such as the LED circuit, power supply, etc. can be dismantled and recycled via appropriate facilities.