

Z.I des Ajeux - 72400 La Ferté-Bernard - France
Tél. : +33 (0)2 43 60 40 00 / Fax : +33 (0)2 43 60 40 09

 www.securlite.com

Product, technical characteristics and features

| Désignation | L | A | B | C |
|---------------------------------|------|-----|------|----|
| 1/2x 1 LLC plastic end caps | 370 | 80 | 210 | 60 |
| 1/2x 1 LLC metal end caps | 370 | 80 | 210 | 47 |
| 1/2x 1 LLC DPP plastic end caps | 435 | 80 | 275 | 60 |
| 1/2x 1 LLC DPP metal end caps | 435 | 80 | 275 | 47 |
| 1/2x 2 LLC plastic end caps | 650 | 130 | 390 | 70 |
| 1/2x 2 LLC metal end caps | 650 | 130 | 390 | 57 |
| 1/2x 2 LLC DPP plastic end caps | 715 | 130 | 455 | 70 |
| 1/2x 2 LLC DPP metal end caps | 715 | 130 | 455 | 57 |
| 1/2x 3 LLC plastic end caps | 930 | 130 | 670 | 70 |
| 1/2x 3 LLC metal end caps | 930 | 130 | 670 | 57 |
| 1/2x 3 LLC DPP plastic end caps | 995 | 130 | 735 | 70 |
| 1/2x 3 LLC DPP metal end caps | 995 | 130 | 735 | 57 |
| 1/2x 4 LLC plastic end caps | 1210 | 130 | 950 | 70 |
| 1/2x 4 LLC metal end caps | 1210 | 130 | 950 | 57 |
| 1/2x 4 LLC DPP plastic end caps | 1275 | 130 | 1015 | 70 |
| 1/2x 4 LLC DPP metal end caps | 1275 | 130 | 1015 | 57 |

Standard installation kit:

Rubber washer **x4**
Metallic washer **x4**

General characteristics:

Nominal voltage: **220 - 240V AC – 50 / 60 Hz**
Input voltage range: **198 - 264V AC**
Protection class: **I**
Protection rating: **IP65**
Mechanical impact resistance rating:
IK11 / 50 j (plastic end caps).
IK11++ / 150 j (metallic end caps).

Light source: LED - this product contains a light source of energy efficiency class C.

Power(s): as per label product.

Reference(s): as per label product.

- Standard reference: 65-66xxx**00** no detection (see this instruction).
- Options regarding the end of product's reference (see specific instructions).

Other reference(s) with option(s):

- See specific instructions.

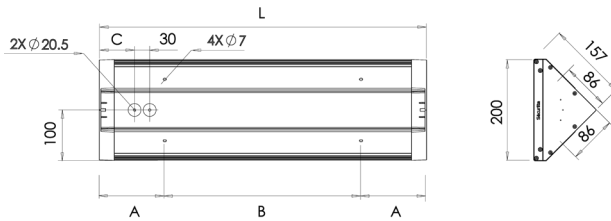

Angle version :

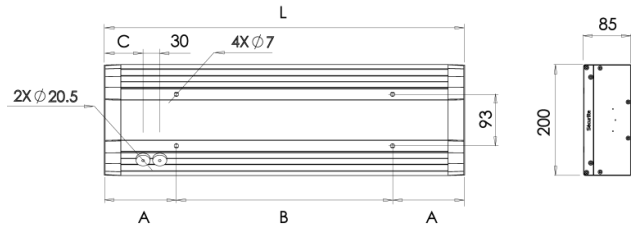

Wall mounted version :



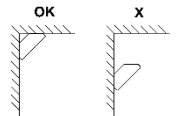

Conditions of use

- Horizontal position:** OK ( *Horizontal position: for angle version installation in the corner between wall and ceiling.*)
- Vertical position:** OK ( *Vertical position: for angle version installation in a corner between two walls.*)



Mounting / Installation

-  *Fitting & installation must be carried out by a professional installer in accordance with current installation standards.*
-  *Isolate the power before fitting and connecting up.*
-  *Warning, versions employing LEDs are at risk from ESD (electrostatic discharges).*

Opening the luminaire:

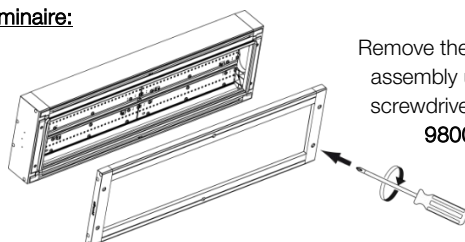

Remove the frame + diffuser assembly using a suitable screwdriver fitted with the **98000003** bit

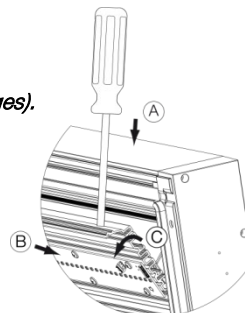

A – Insert a flat-bladed screwdriver into the gap between the aluminium profiles.

B+C – Use the screwdriver as a lever every **20-30 cm** to unclip the geartray.

Remove the geartray:

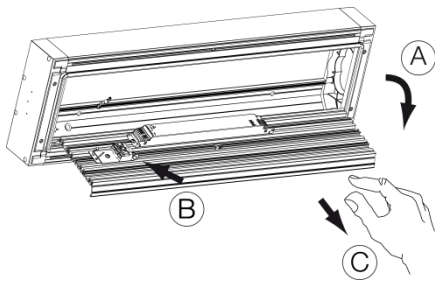

- A – Turn the geartray.
- B – Disconnect the earth cable from the holder connector.
- C – Remove the geartray.

Fixing:

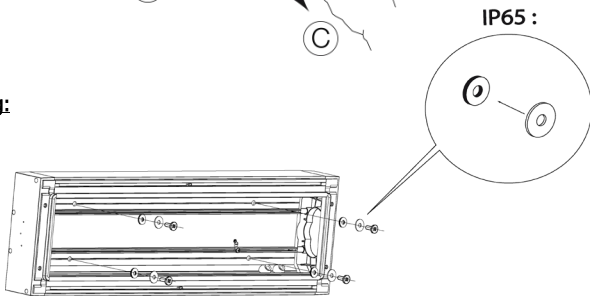

For mounting the luminaire, use 5 mm diameter flat-headed screws with fixing plugs suitable for the type of wall, in order to achieve optimum rip-out resistance. The screws and plugs are not supplied with the luminaire. Use the rubber and metallic washer in order to maintain the sealing of the product. Use the pre-drilled holes to fix the luminaire.

Preparing the cable entry grommet class 1 (Standard reference 65-66xxxx00):

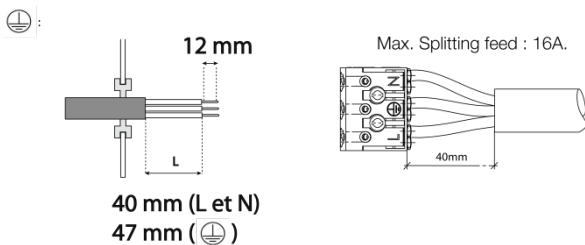

The cable must be prepared as per the diagrams. Respect the polarity.

- For other cases, refer to the specific instructions for connection and splitting off.

Closing the luminaire:

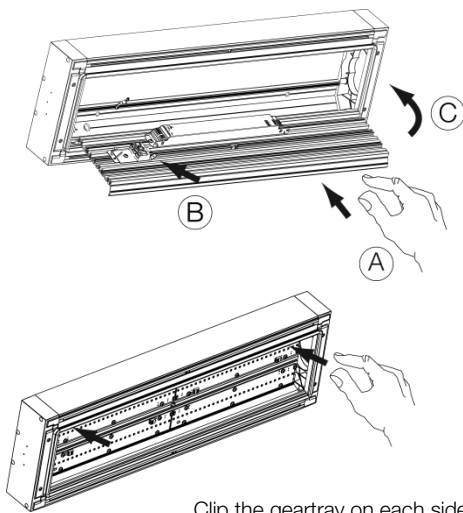

- A – Insert the geartray.
- B – Connect the earth cable to the holder connector.
- C – Turn the geartray.

Clip the geartray on each side of the luminaire.

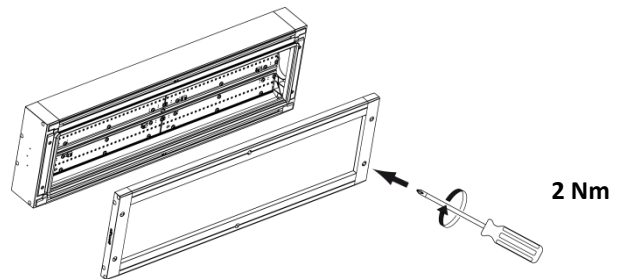

Refit the frame + diffuser assembly using a suitable screwdriver fitted with the **98000003** vandal-resistant bit.

Cleaning

Cleaning of the luminaire is limited to cleaning the diffuser for proper light output. Clean the diffuser (luminaire must be closed) using a damp cloth or with soapy water.

 **DO NOT USE DETERGENT**

Maintenance

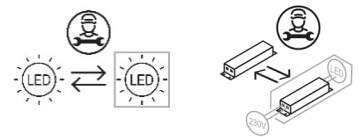

 The light source and the control gear contained in this luminaire must only be replaced by the manufacturer or his service agent or a similar qualified person.

Recyclability



The URBALINE is an eco-designed luminaire:

- All the plastic or metal components can be dismantled and recycled via appropriate facilities.
- All the electronic components such as the LED circuit, power supply, etc. can be dismantled and recycled via appropriate facilities.